

## SUBTRACKT<sup>TM</sup> SYSTEM



### FEATURES

Beneath the surface sits the Subtrackt collection. This structural system is designed to seamlessly integrate into the architecture. An extremely versatile recessed system allows for perfect cove applications with optional single or dual channels to line your ceiling in a geometric formation or squared design. The modules provide four way movements offering additional angles to optimize directional illumination with its mechanical arm design.

NUMBER	38656
WATTAGE	15W Integrated LED
BEAM ANGLE	40°
VERTICAL ROTATION	90°/200°
HORIZONTAL ROTATION	130°
KELVIN	2700K/3000K/3500K/4000K
LUMENS	1380lm
CRI	90+
DIMMING	TRIAC
ADJUSTABLE HEAD	Yes
COLOR	White
INPUT	120-277V

**SHOWN:** Single channel recessed slot, 38656-30-02

### CERTIFICATIONS



### ORDERING TABLE

SUBTRACKT HEAD	KELVIN	COLOR	PRODUCT CODES
38656	2700K	BLACK (01)	38656-27-01
		WHITE (02)	38656-27-02
	3000K	BLACK (01)	38656-30-01
		WHITE (02)	38656-30-02
	3500K	BLACK (01)	38656-35-01
		WHITE (02)	38656-35-02
	4000K	BLACK (01)	38656-40-01
		WHITE (02)	38656-40-02

TRACK	COLOR	PRODUCT CODES
38653	BLACK (01)	38655-01
	WHITE (02)	38653-02
41900	BLACK (01)	41900-01
	WHITE (02)	41900-02

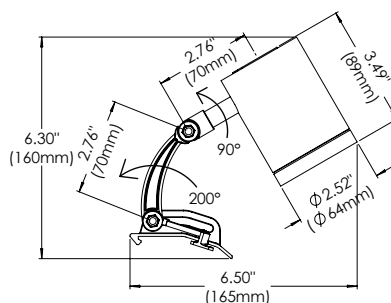

COVE MEASUREMENTS

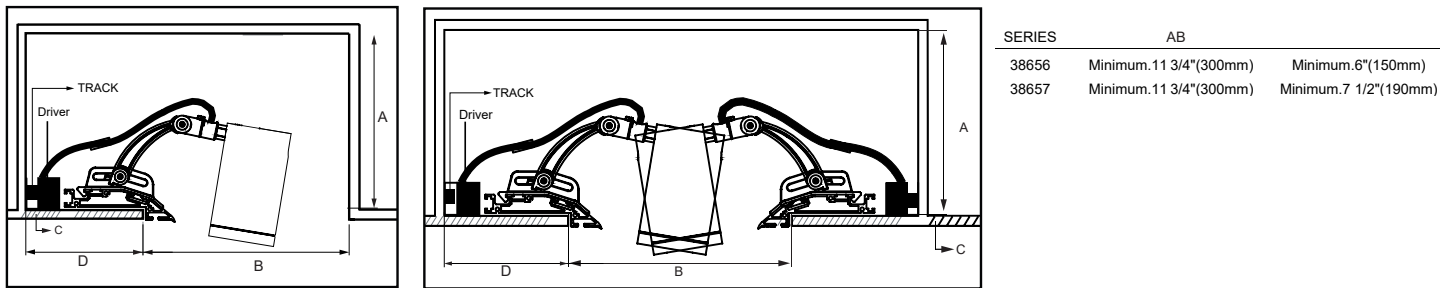

SAMPLE APPLICATIONS

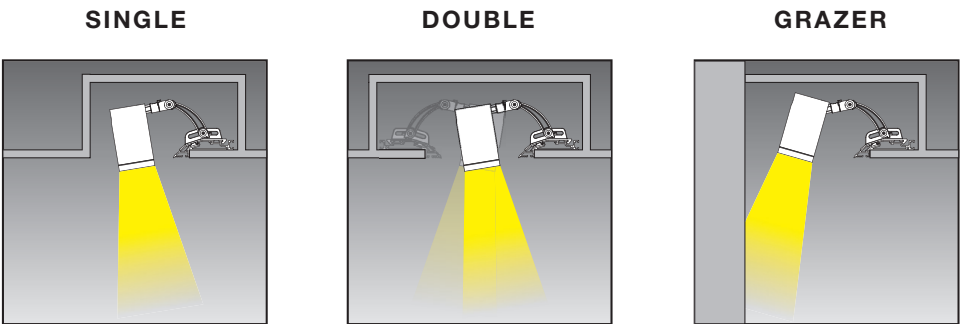

PHOTOMETRICS (METRICS)

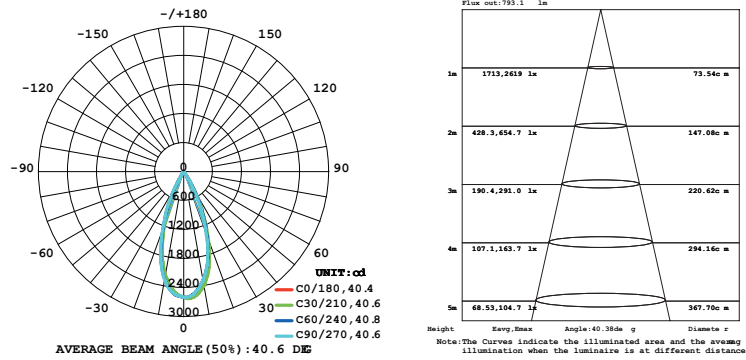

15W SPOT

PHOTOMETRICS (IMPERIAL)

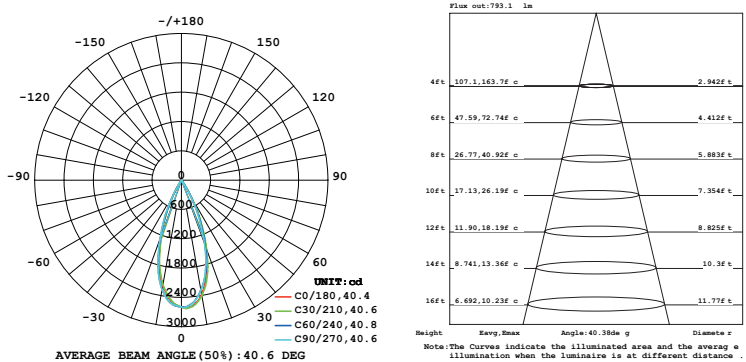

15W SPOT



**38653-01**  
CHANNE L MOUNT, 6.5FT, B LACK

**38653-02**  
CHANNE L MOUNT, 6.5FT, W HITE

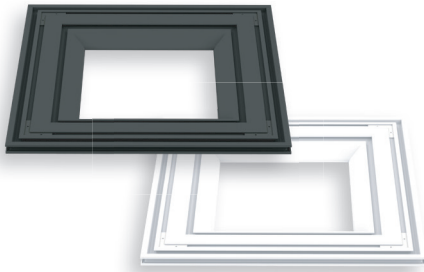
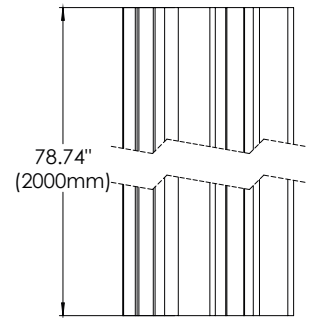

**41900-01**  
CHANNE L MOUNTS QUARE, BLACK

**41900-02**  
CHANNE L MOUNT, SQUARE, W HITE

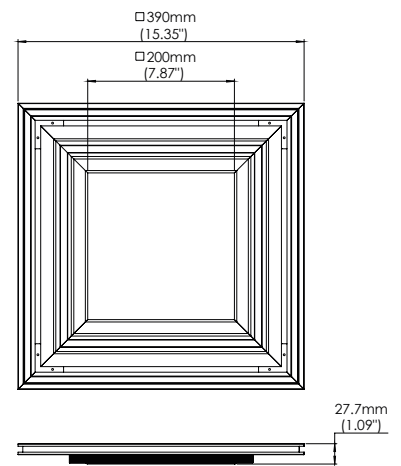

## POWER CONNECTION

### HALO TRACK

- Single circuit track, 3-conductor, 20A maximum per circuit
- Can be surface mounted on walls or ceilings
- Field cuttable to desired length
- Use components to build any desired configuration
- Includes 2 dead-end covers

#### **1002** 2-FOOT TRACK



#### **1004** 4-FOOT TRACK



#### **1008** 8-FOOT TRACK



-01 Black

-02 White

